

BurstPro G2 Compact

BurstPro G2 is a circular shaped, exterior-rated and cost-effective architectural LED floodlight that is designed for façade, landscape and outdoor flood lighting applications.

The robust mechanical design and high-efficient optical design make it ideal for illuminating multi-story exterior facades, bridges, landmarks and monuments.

Available in white, monochromatic colors, RGB, RGBW and tunable white.

Six different spread lenses ranging from narrow spot to wide flood and DMX512/RDM control option available to give architects and designers the freedom to explore a wide range of concepts and design with no limitations.



Key Features

- Standard: RGBW, RGB, 2700K, 3000K and 4000K
- Optional 5000K, Monochromatic Colors and Tunable White
- Wide Range of Beam Angles from Narrow Spot to Wide Flood
- 1 foot-candle at up to 50m (4000K, 10° lens)
- Robust Design & IP66 rating for outdoor use
- Adjustable $\pm 90^\circ$ tilting angle
- Available in DMX512/RDM control interface option

Ordering guide

BVP379 C 12LED 27K 220V 30 24W HE

BVP379 C	12LED		220V			24W	HE
Family	# of LEDs	CCT / Color	Voltage	Beam Angles	Control	Wattage	Version
BVP379 C– BurstPro G2 Compact	12LED	27K – 2700K 30K – 3000K 40K – 4000K 50K – 5000K RGB – RGB ⁽¹⁾ tW – Tunable White RGBWW – RGBW(3000K) RGBNW – RGBW(4000K) BL – Blue RD – Red GN – Green AM – Amber	220V – 220-240V AC	10 – 10°x10° 15 – 15°x15° 30 – 30°x30° 45 – 45°x45° 60 – 60°x60°	– On/Off DMX – DMX/RDM	24W	HE – high efficiency version

(1) RGB, tW and RGBW are available only in DMX control

Rev. 202210

© 2019 Signify Holding. All rights reserved.
Specifications may change without notice.

Product Data

Product Family	BurstPro G2Compact (BVP379 C)
Dimensions (W x H x D)	Ø135 x 142 mm (with bracket)
Source	High power LED
Lumen Maintenance	White: 50,000 hrs L70 at 35°C RGB: 50,000 hrs L50 at 35°C
Housing	Die-cast aluminum
Finishing	Electrostatically applied polyester powder coating
Color	Dark Grey (RAL7012)
Bracket	Cold-rolled steel
Adjustability	Tilting angle $\pm 90^\circ$
Lenses	Anti-aging and anti-UV high optical efficiency PMMA lenses
Gasket	Silicon
Cover	Clear tempered glass
Max Weight	1.8 kg
Control	On/Off DMX512/RDM
Input Voltage	220-240 VAC, 50/60Hz
Inrush Current	Max 60A (cold start 230Vac/50Hz measured at 50% Ipeak)
Maximum Number of Luminaires on 16A MCB	40 units (Type C)
Total Harmonic Distortion	< 20% (230Vac/50Hz, full load)
IEC Classification	Class I
Power Cable	3 pole round cable L=50cm, 3x1.0mm ² with flying wires
Signal Cable	4 pole round cable L=50cm, 4x0.5mm (DMX versions only)
Cables Connectors	IP67 male/female connectors for DMX through wiring (DMX versions only)
Number of LEDs	12LED
Beam Angles	10°, 15°, 30°, 45°, 60°
Max Power Consumption	24
Standard CCT	2700K, 3000K, 4000K
Standard Colors	RGB, RGBW(4000K)
Standard CRI	80
White SDCM	4
Colors Wavelengths	R: 620 to 625nm; G: 525 to 530nm; B: 470 to 475nm
Temperature Range	-40°C to 50°C (Operating) -35°C to 50°C (Startup) -40°C to 70°C (Storage)
Protection Rating	IP66, IK06
Certifications	CE, CB, CQC, RoHS
Warranty	3 Years

Rev. 202210

Luminaire Dimensions:

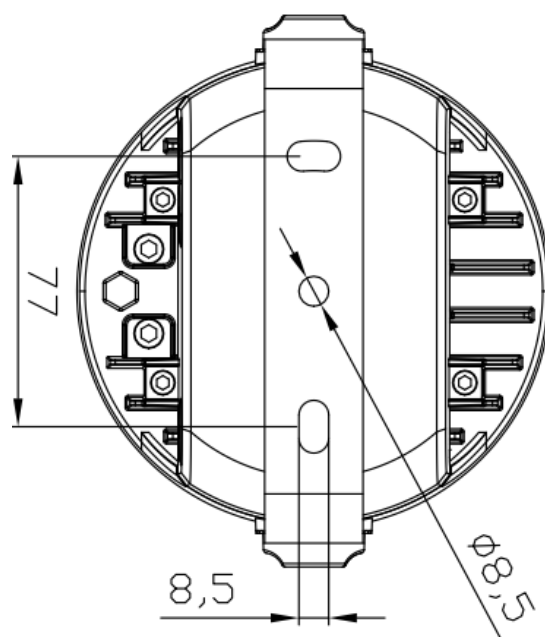
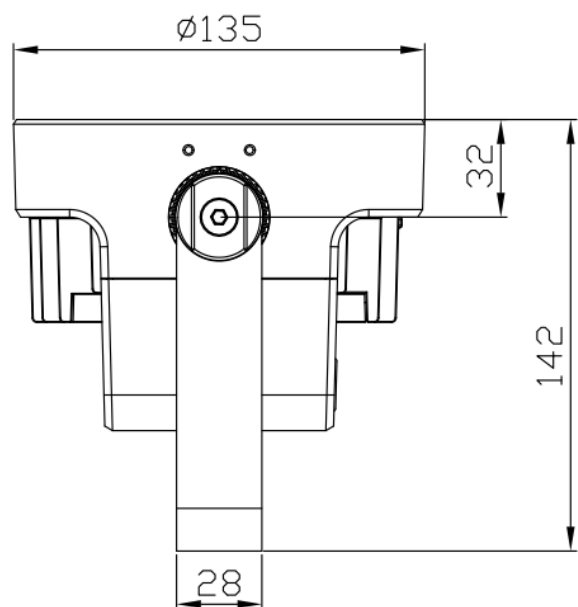

Rev. 202210

Polar Candela Distribution Curves:

10x10° Beam Angle

Features:

The 10x10° beam angle offers a narrow beam that can be used to highlight a small area in a building or making an ornament stands out.

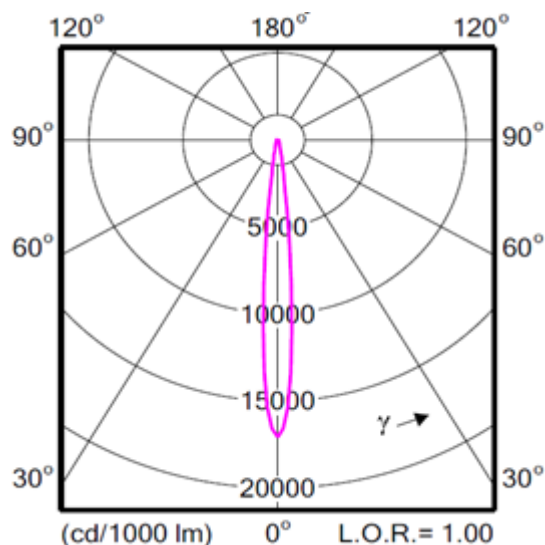

15x15° Beam Angle

Features:

The 15x15° beam angle offers a medium that can be used to highlight a small to medium area in a building or making an ornament stands out.

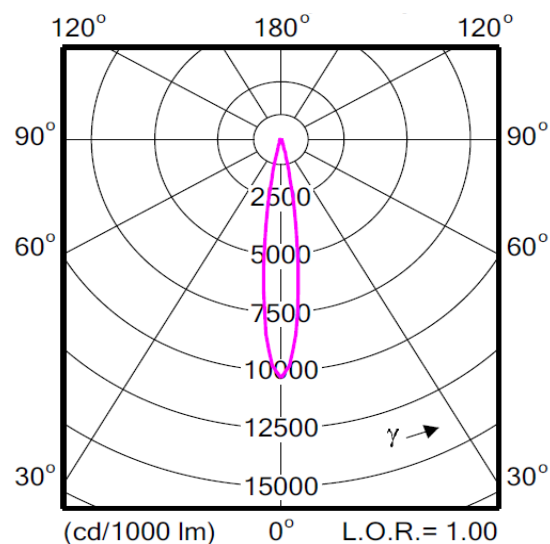

30x30° Beam Angle

Features:

The 30x30° beam angle offers a wide beam that can be used for highlighting medium to large areas in a building or used for general façade lighting.

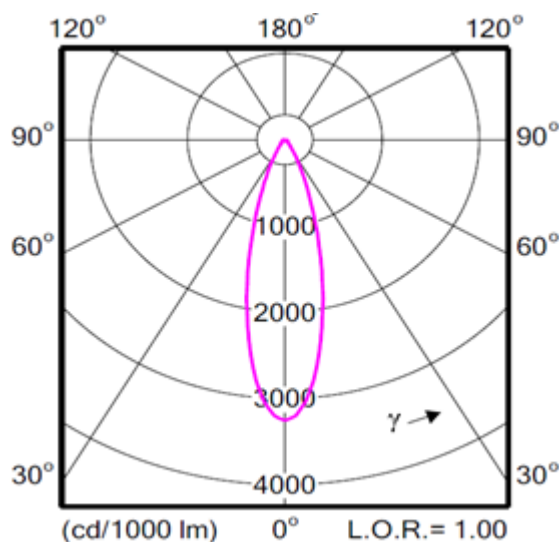

Polar Candela Distribution Curves:

45x45° Beam Angle

Features:

The 45x45° beam angle offers a wide beam that can be used for highlighting large and wide areas in a building or used for general façade lighting.

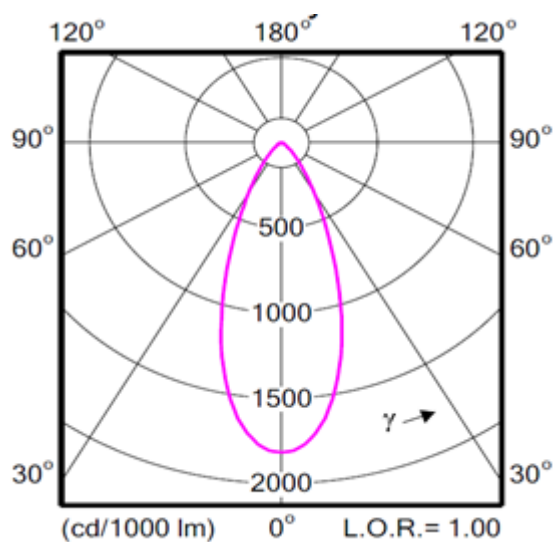

60x60° Beam Angle

Features:

The 60x60° beam angle offers a wide flood distribution that can be used to highlight larger and wider areas in a building or for general façade lighting.

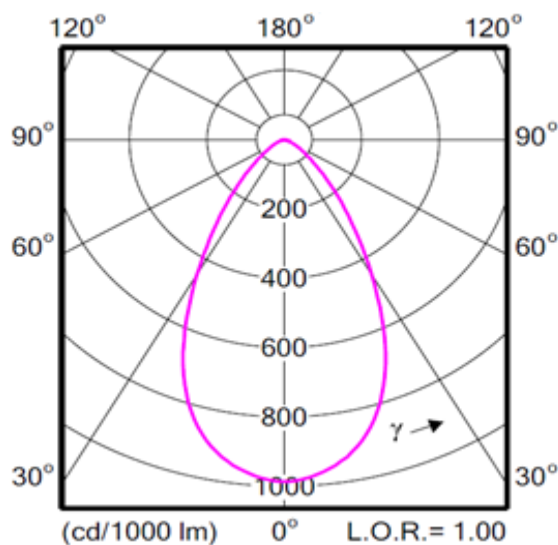

Order Information:

I2NC	Description	Power(W)
	BVP379 C 12LED 27K 220V 10 24W HE	24W
	BVP379 C 12LED 27K 220V 10 DMX 24W HE	24W
	BVP379 C 12LED 27K 220V 15 24W HE	24W
	BVP379 C 12LED 27K 220V 15 DMX 24W HE	24W
	BVP379 C 12LED 27K 220V 30 24W HE	24W
	BVP379 C 12LED 27K 220V 30 DMX 24W HE	24W
	BVP379 C 12LED 27K 220V 45 24W HE	24W
	BVP379 C 12LED 27K 220V 45 DMX 24W HE	24W
	BVP379 C 12LED 27K 220V 60 24W HE	24W
	BVP379 C 12LED 27K 220V 60 DMX 24W HE	24W
	BVP379 C 12LED 30K 220V 10 24W HE	24W
	BVP379 C 12LED 30K 220V 10 DMX 24W HE	24W
	BVP379 C 12LED 30K 220V 15 24W HE	24W
	BVP379 C 12LED 30K 220V 15 DMX 24W HE	24W
	BVP379 C 12LED 30K 220V 30 24W HE	24W
	BVP379 C 12LED 30K 220V 30 DMX 24W HE	24W
	BVP379 C 12LED 30K 220V 45 24W HE	24W
	BVP379 C 12LED 30K 220V 45 DMX 24W HE	24W
	BVP379 C 12LED 30K 220V 60 24W HE	24W
	BVP379 C 12LED 30K 220V 60 DMX 24W HE	24W
	BVP379 C 12LED 40K 220V 10 24W HE	24W
	BVP379 C 12LED 40K 220V 10 DMX 24W HE	24W
	BVP379 C 12LED 40K 220V 15 24W HE	24W
	BVP379 C 12LED 40K 220V 15 DMX 24W HE	24W
	BVP379 C 12LED 40K 220V 30 24W HE	24W
	BVP379 C 12LED 40K 220V 30 DMX 24W HE	24W

¹Other options are available upon request

Order Information:

I2NC	Description	Power(W)
	BVP379 C 12LED 40K 220V 45 24W HE	24W
	BVP379 C 12LED 40K 220V 45 DMX 24W HE	24W
	BVP379 C 12LED 40K 220V 60 24W HE	24W
	BVP379 C 12LED 40K 220V 60 DMX 24W HE	24W
	BVP379 C 12LED RGB 220V 10 DMX 24W HE	24W
	BVP379 C 12LED RGB 220V 15 DMX 24W HE	24W
	BVP379 C 12LED RGB 220V 30 DMX 24W HE	24W
	BVP379 C 12LED RGB 220V 45 DMX 24W HE	24W
	BVP379 C 12LED RGB 220V 60 DMX 24W HE	24W
	BVP379 C 12LED RGBNW 220V 10 DMX 24W HE	24W
	BVP379 C 12LED RGBNW 220V 15 DMX 24W HE	24W
	BVP379 C 12LED RGBNW 220V 30 DMX 24W HE	24W
	BVP379 C 12LED RGBNW 220V 45 DMX 24W HE	24W
	BVP379 C 12LED RGBNW 220V 60 DMX 24W HE	24W
	BVP379 C 12LED RGBWW 220V 10 DMX 24W HE	24W
	BVP379 C 12LED RGBWW 220V 15 DMX 24W HE	24W
	BVP379 C 12LED RGBWW 220V 30 DMX 24W HE	24W
	BVP379 C 12LED RGBWW 220V 45 DMX 24W HE	24W
	BVP379 C 12LED RGBWW 220V 60 DMX 24W HE	24W

¹Other options are available upon request

Accessories:

Description
ZXP390 Lead 4P DMX cable 2m (10 pcs)
ZXP390 Jump 4P DMX cable 2m (10 pcs)
ZXP390 endcap male connector (20 pcs)
ZXP390 endcap female connector (20 pcs)

¹ Different cables lengths are available upon request

² End caps must be used at the end of each run

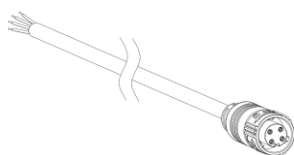

Leader cable 4P DMX 2m

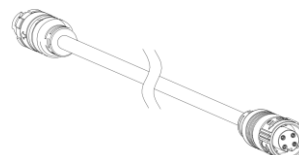

Jumper cable 4P DMX 2m

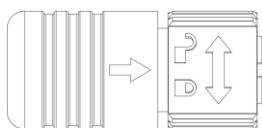

End cap for male connectors

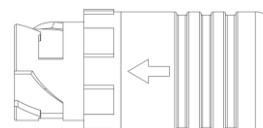

End cap for female connectors

Rated System Lumen Output ($\pm 10\%$):

CCT/Color (All channels On)	10°	15°	30°	45°	60°
	DMX	DMX	DMX	DMX	DMX
2700K	1440	1500	1705	1280	1235
3000K	1505	1565	1780	1335	1290
4000K	1675	1750	1985	1485	1440
RGB	880	920	1040	780	755
RGBNW	1090	1140	1290	970	940

