

iGrazer Large - (BCP389 L)

Brush and iGrazer are surface mounted, exterior-rated and compact sized LED wall washing and grazing luminaires that are designed for façade and outdoor architectural lighting applications. The robust mechanical and unique optical designs make them ideal for illuminating buildings facades, bridges, overpasses and any application that requires a linear lighting solutions. Available in white, monochromatic colors, RGB, RGBW and tunable white.

AC powered with integrated driver, various spread lenses, DMX control option with up to 6 pixels (6IDs) and signal through wiring available to give architects and designers the freedom to explore a wide range of concepts and design with no limitations..



Key Features (BCP389 L)

- AC powered 220-240V 50/60Hz
- Standard: RGBW, RGB, 2700K, 3000K and 4000K
- Optional 5000K, Monochromatic Colors and Tunable White
- Standard 300, 500 and 1000mm lengths
- Up to 6IDs (6 pixels) for easy and flexible control
- Symmetrical and asymmetrical optical distributions
- Robust Design & IP66 rating for outdoor use
- Adjustable +15° to -90° tilting angle
- Available in DMX control interface option

Ordering guide

ex: BCP389 L 40K 220V 17 L100 DMX

BCP389		220V		L		
Family	Type / Size	CCT / Color	Voltage	Beam Angle	Length	Control/Pixels ^{(1) (2)}
BCP389 – UniStrip G4	L - Large	27K – 2700K 30K – 3000K 40K – 4000K 50K – 5000K RGB – RGB RGBWW – RGBW(3000K) RGBNW – RGBW(4000K) BL – Blue RD – Red GN – Green AM – Amber tW – Tunable White	220V – 220V-240V AC	A2 – 16x35° 17 – 17° 30 – 30° 40 – 40°	L30 – 300mm L50 – 500mm L100 – 1000mm	– On/Off DMX – DMX 1 Pixel 2PX – DMX 2 Pixels 3PX – DMX 3 Pixels 4PX – DMX 4 Pixels 6PX – DMX 6 Pixels

(1) RGB, RGBW and tW are only available in DMX
 (2) For detailed Pixels of each length/option, please check the table next page

Product Data

Product Family	iGrazer (BCP389 L)		
Dimensions (L x W x H)	300/500/1000mm x 105mm x 80mm (with bracket) 300/500/1000mm x 53mm x 65mm (without bracket)		
Source	High power LED		
Lumen Maintenance	White: 50,000 hrs L70 at 35°C RGB: 50,000 hrs L50 at 35°C		
Housing	Extruded aluminum with die-cast aluminum end caps		
Finishing	Electrostatically applied polyester powder coating		
Color	Dark Grey (RAL7012)		
Bracket	Aluminum plate and stainless steel		
Adjustability	Tilting angle +15° to -90°		
Lenses	Anti-aging and anti-UV high optical efficiency PMMA lenses		
Gasket	Silicon		
Cover	Clear tempered glass		
Control Interfaces	On/Off DMX12		
Input Voltage	220-240 VAC, 50/60Hz		
Total Harmonic Distortion	< 20%		
IEC Classification	Class I		
Power Cable (On/Off)	3 pole round cable L=30cm, 3x1.0mm ² with flying wires		
Signal Cable (DMX)	4 pole flat cable L=30cm, 4x0.50mm ² (DMX versions only)		
Cables Connectors	IP67 Male/Female connectors for DMX through wiring (DMX versions only)		
Lengths	300mm	500mm	1000mm
Standard Number of LEDs	9LED (WH)	18LED (WH)	36LED (WH)
	12LED (RGB/RGBW)	24LED (RGB/RGBW)	48LED (RGB/RGBW)
Max Power Consumption	20W	40W	80W
Max Inrush Current	40A/450µs	60A/850µs	
Maximum No. of Lum on 16A MCB	Type B	6	4
	Type C	11	8
Number of Pixels (IDs)	White	1	1, 2, 3
	RGB/RG BW		1, 2
Max Weight	1.8 kg	2.5 kg	4.5 kg
Standard CCT/Colors	2700K, 3000K, 4000K, RGB, RGBW(4000K)		
Standard Optics	16x35°, 17°, 30°, 40°		
Standard CRI	80		
White SDCM	4		
Colors Wavelength	R: 620 to 625nm; G: 525 to 530nm; B: 470 to 475nm		
Temperature Range	-40°C to 50°C (Operating) -35°C to 50°C (Startup) -40°C to 70°C (Storage)		
Protection Rating	IP66, IK06		
Certifications	CE, CB, CQC (all in progress)		
Warranty	3 Years		

(1) cold start 230Vac/50Hz measured at 50% lpeak

Luminaire Dimensions:

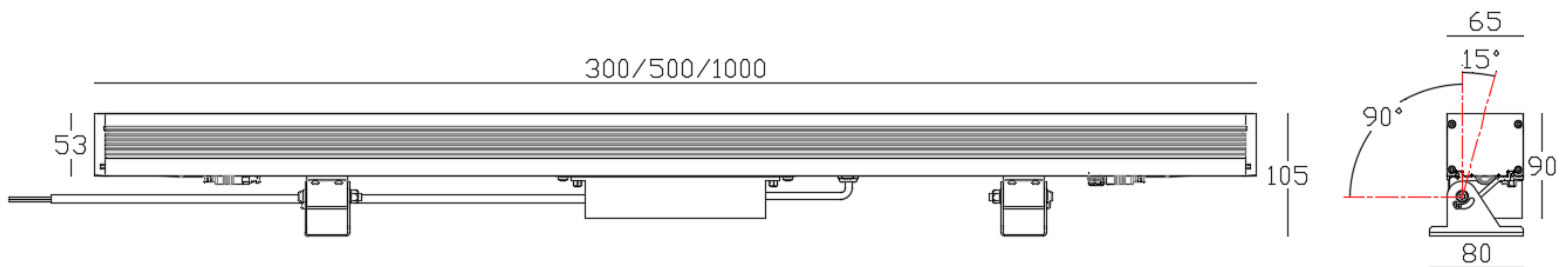

Polar Candela Distribution Curves:

17x17° Beam Angle

Features:

The 17x17° beam angle delivers an excellent light control that can reach higher than other optics
Available for all options except RGBW

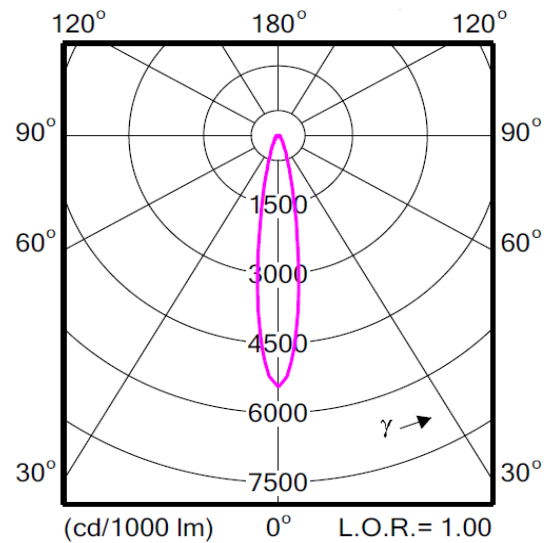

A2: 16x35° Beam Angle

Features:

The 16x35° beam angle offers significant and even light output.
Move it closer to the surface to get a higher concentrated effect.
Available for all options except RGBW

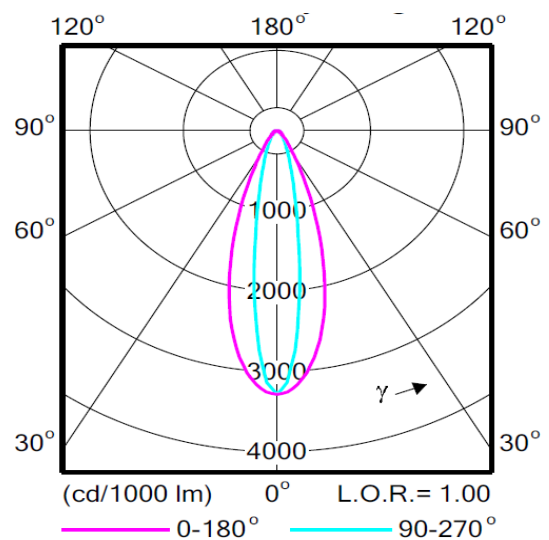

Polar Candela Distribution Curves:

30x30° Beam Angle

Features:

The 30x30° beam angle offers a symmetrical distribution with perfect uniformity. Move it closer to the surface to get a more concentrated light.

Available for all versions

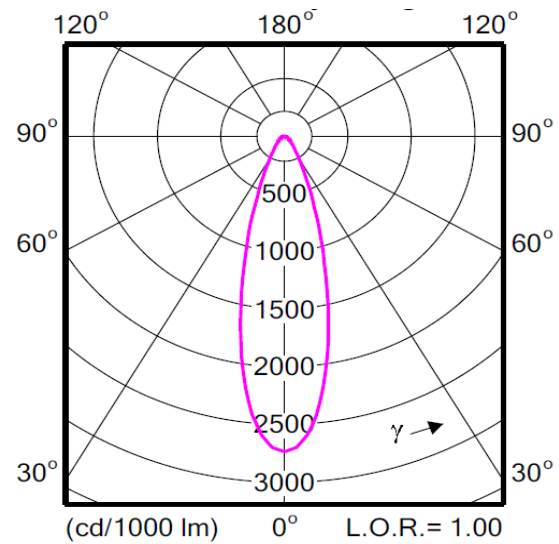

40x40° Beam Angle

Features:

The 40x40° beam angle offers a symmetrical distribution with perfect uniformity. Move it closer to the surface to get a concentrated light.

Available for all versions except RGBW

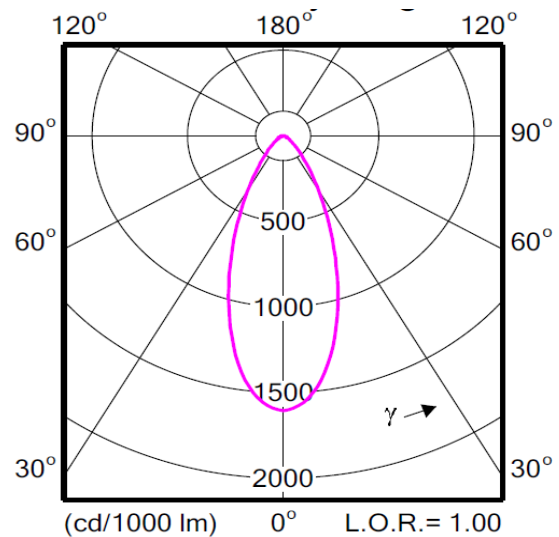

Order Information:

Description
BCP389 L 27K 220V A2 L50
BCP389 L 27K 220V A2 L50 DMX
BCP389 L 27K 220V 40 L50
BCP389 L 27K 220V 40 L50 DMX
BCP389 L 30K 220V A2 L50
BCP389 L 30K 220V A2 L50 DMX
BCP389 L 30K 220V 40 L50
BCP389 L 30K 220V 40 L50 DMX
BCP389 L 40K 220V A2 L50
BCP389 L 40K 220V A2 L50 DMX
BCP389 L 40K 220V 40 L50
BCP389 L 40K 220V 40 L50 DMX
BCP389 L RGBNW 220V A2 L50 DMX
BCP389 L RGBNW 220V 40 L50 DMX
BCP389 L RGB 220V A2 L50 DMX
BCP389 L RGB 220V 40 L50 DMX
BCP389 L 27K 220V A2 L100
BCP389 L 27K 220V A2 L100 DMX
BCP389 L 27K 220V 40 L100
BCP389 L 27K 220V 40 L100 DMX
BCP389 L 30K 220V A2 L100
BCP389 L 30K 220V A2 L100 DMX
BCP389 L 30K 220V 40 L100
BCP389 L 30K 220V 40 L100 DMX
BCP389 L 40K 220V A2 L100
BCP389 L 40K 220V A2 L100 DMX
BCP389 L 40K 220V 40 L100
BCP389 L 40K 220V 40 L100 DMX

¹Other options are available upon request

Order Information:

Description
BCP389 L RGBNW 220V A2 L100 DMX
BCP389 L RGBNW 220V 40 L100 DMX
BCP389 L RGB 220V A2 L100 DMX
BCP389 L RGB 220V 40 L100 DMX
BCP389 L 27K 220V A2 L30
BCP389 L 27K 220V A2 L30 DMX
BCP389 L 27K 220V 40 L30
BCP389 L 27K 220V 40 L30 DMX
BCP389 L 30K 220V A2 L30
BCP389 L 30K 220V A2 L30 DMX
BCP389 L 30K 220V 40 L30
BCP389 L 30K 220V 40 L30 DMX
BCP389 L 40K 220V A2 L30
BCP389 L 40K 220V A2 L30 DMX
BCP389 L 40K 220V 40 L30
BCP389 L 40K 220V 40 L30 DMX
BCP389 L RGBNW 220V A2 L30 DMX
BCP389 L RGBNW 220V 40 L30 DMX
BCP389 L RGB 220V A2 L30 DMX
BCP389 L RGB 220V 40 L30 DMX

¹Other options are available upon request

Accessories

Description
BCP389 L L30 glare shield (24 pcs)
BCP389 L L50 glare shield (12 pcs)
BCP389 L L100 glare shield (12 pcs)
ZXP390 Lead 4P DMX cable 2m (10 pcs)
ZXP390 Jump 4P DMX cable 2m (10 pcs)
ZXP390 endcap male connector (20 pcs)
ZXP390 endcap female connector (20 pcs)

¹ Different cables lengths are available upon request

² End caps must be used at the end of each run

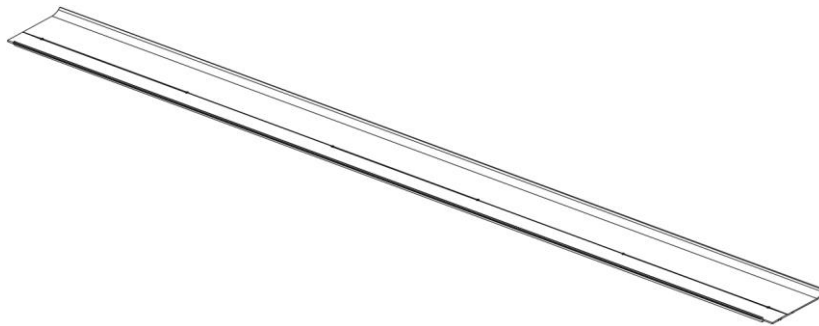

Glare Shield

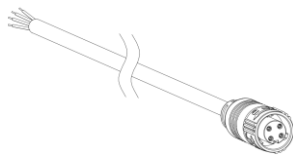

Leader cable 4P DMX 2m

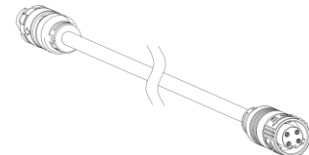

Jumper cable 4P DMX 2m

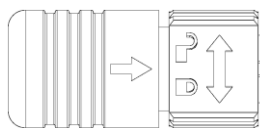

End cap for male connectors

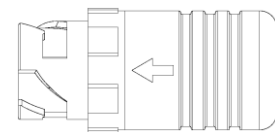

End cap for female connectors

Rated System Lumen Output ($\pm 10\%$):

BCP389 L L30

CCT/Color (All channels On)	17°	30°	40°	A2°
	DMX	DMX	DMX	DMX
2700K	1,050	1,080	1,030	1,000
3000K	1,120	1,160	1,100	1,070
4000K	1,280	1,320	1,260	1,220
RGB	720	740	710	690
RGBNW	830	850	810	790

BCP389 L L50

CCT/Color (All channels On)	17°	30°	40°	A2°
	DMX	DMX	DMX	DMX
2700K	2,060	2,120	2,020	1,960
3000K	2,200	2,270	2,160	2,100
4000K	2,510	2,580	2,460	2,390
RGB	1,440	1,490	1,420	1,380
RGBNW	1,650	1,700	1,620	1,570

BCP389 L L100

CCT/Color (All channels On)	17°	30°	40°	A2°
	DMX	DMX	DMX	DMX
2700K	4,120	4,240	4,040	3,920
3000K	4,410	4,530	4,320	4,200
4000K	5,020	5,170	4,930	4,780
RGB	2,890	2,970	2,830	2,750
RGBNW	3,320	3,420	3,260	3,160

Rated System Lumen Output ($\pm 10\%$):

BCP389 Pro L100 – 48LED

CCT/Color (All channels On)	7°	A1°	A5°
	DMX	DMX	DMX
2700K	5,700	5,290	–
3000K	6,100	5,660	–
4000K	6,950	6,450	–
RGB	–	3,390	3,020

BCP389 Pro L100 – 60LED

CCT/Color (All channels On)	7°	A1°	A5°	A7°
	DMX	DMX	DMX	DMX
2700K	7,120	6,610	–	–
3000K	7,620	7,070	–	–
4000K	8,690	8,060	–	–
RGB	–	5,090	4,580	–
12LED RGBNW	–	–	–	3,050

