

BurstPro Medium

BurstPro is a circular shaped, exterior-rated and cost-effective architectural LED floodlight that is designed for façade, landscape and outdoor flood lighting applications.

The robust mechanical design and high-efficient optical design make it ideal for illuminating multi-story exterior facades, bridges, landmarks and monuments.

Available in white, monochromatic colors, RGB, RGBW and tunable white.

Six different spread lenses ranging from narrow spot to wide flood and DMX512/RDM control option available to give architects and designers the freedom to explore a wide range of concepts and design with no limitations.



Key Features

- Standard: RGBW, RGB, 2700K, 3000K and 4000K
- Optional 5000K, Monochromatic Colors and Tunable White
- Wide Range of Beam Angles from Narrow Spot to Wide Flood
- 1 foot-candle at up to 134m (4000K, 3.5° lens)
- Robust Design & IP66 rating for outdoor use
- Adjustable $\pm 90^\circ$ tilting angle
- Available in DMX512/RDM control interface option

Ordering guide

ex: *BVP329 M 36LED RGBNW 220V 15 DMX*

| BVP329 | M | | | 220V | | |
|--------------------------------|-------------|--|--|-----------------------|--|-------------------------------|
| <u>Family</u> | <u>Size</u> | <u># of LEDs</u> | <u>CCT / Color</u> | <u>Voltage</u> | <u>Beam Angl</u> | <u>Control ⁽⁴⁾</u> |
| BVP329 – BurstPro Medium | M - Medium | 18LED ⁽¹⁾ 24LED 36LED | 27K – 2700K 30K – 3000K 40K – 4000K 50K – 5000K RGB – RGB tW – Tunable White RGBWW – RGBW(3000K) ⁽¹⁾ RGBNW – RGBW(4000K) ⁽²⁾ BL – Blue RD – Red GN – Green AM – Amber | 220V – 220-240V AC | 3 – 3.5x3.5° ⁽³⁾ 8 – 8°x8° 15 – 15°x15° 30 – 30°x30° 40 – 40°x40° 60 – 60°x60° | – On/Off DMX – DMX/RDM |

(1) 18LED is available only in 3.5° beam angle

(2) RGBW is not available for 18LED

(3) Available only for 18LED

(4) RGB, tW and RGBW are available only in DMX control

Product Data

| | | | |
|--|---|------------------------|-------|
| Product Family | BurstPro Medium (BVP329 M) | | |
| Dimensions (W x H x D) | 315 mm x 262 mm 169 mm (with bracket) Ø260 mm x 169 mm (without bracket) | | |
| Source | High power LED | | |
| Lumen Maintenance | White: 50,000 hrs L70 at 35°C RGB: 50,000 hrs L50 at 35°C | | |
| Housing | Die-cast aluminum | | |
| Finishing | Electrostatically applied polyester powder coating | | |
| Color | Dark Grey (RAL7012) | | |
| Bracket | Cold-rolled steel | | |
| Adjustability | Tilting angle ±90° | | |
| Lenses | Anti-aging and anti-UV high optical efficiency PMMA lenses | | |
| Gasket | Silicon | | |
| Cover | Clear tempered glass | | |
| Max Weight | 7kg | | |
| Control | On/Off DMX512/RDM | | |
| Input Voltage | 220-240 VAC, 50/60Hz | | |
| Inrush Current | Max 60A/650µs (cold start 230Vac/50Hz measured at 50% Ipeak) | | |
| Maximum Number of Luminaires on 16A MCB | 4 units (Type B) 8 units (Type C) | | |
| Total Harmonic Distortion | Max 12% (230Vac/50Hz, full load) | | |
| IEC Classification | Class I | | |
| Power Cable | 3 pole round cable L=50cm, 3x1.0mm ² with flying wires | | |
| Signal Cable | 4 pole round cable L=50cm, 4x0.5mm (DMX versions only) | | |
| Cables Connectors | IP67 male/female connectors for DMX through wiring (DMX versions only) | | |
| Number of LEDs | 18LED | 24LED | 36LED |
| Beam Angles | 3.5° | 8°, 15°, 30°, 40°, 60° | |
| Max Power Consumption | 42W | 50W | 80W |
| Standard CCT | 2700K, 3000K, 4000K | | |
| Standard Colors | RGB, RGBW(4000K) | | |
| Standard CRI | 80 | | |
| White SDCM | 4 | | |
| Colors Wavelengths | R: 620 to 625nm; G: 525 to 530nm; B: 470 to 475nm | | |
| Temperature Range | -40°C to 50°C (Operating) -35°C to 50°C (Startup) -40°C to 70°C (Storage) | | |
| Protection Rating | IP66, IK06 | | |
| Certifications | CE, CB, CQC, RoHS | | |
| Warranty | 3 Years | | |

Rev. 20190410

Luminaire Dimensions:

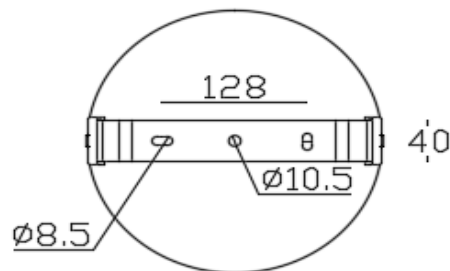
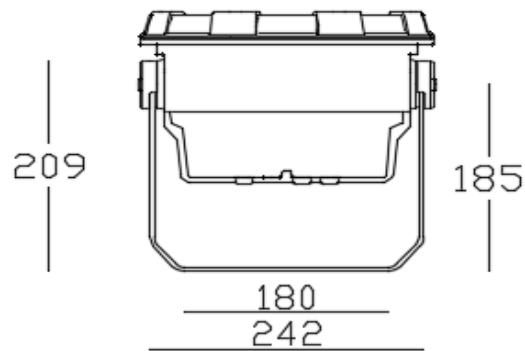
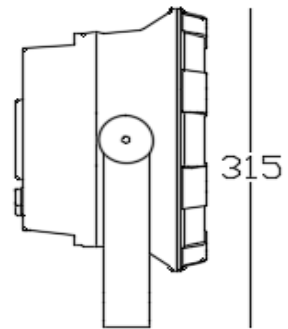
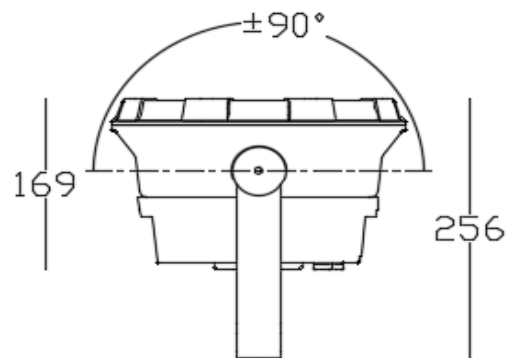
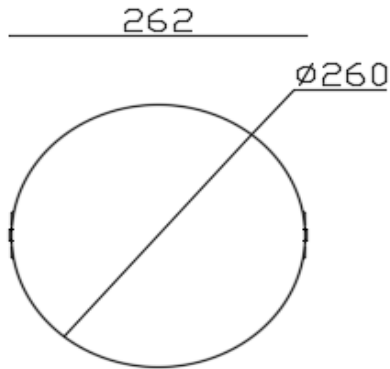

Polar Candela Distribution Curves:

3.5x3.5° Beam Angle

Features:

The 3.5x3.5° beam angle delivers a very narrow beam with more lumens where you want them.

Available only for 6LED version

Not available for RGB or RGBW

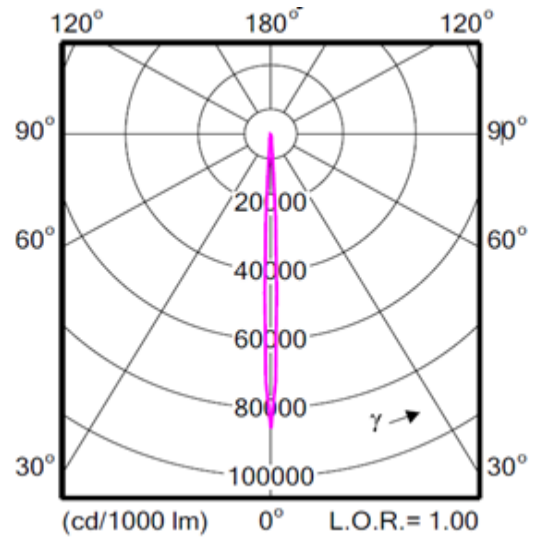

8x8° Beam Angle

Features:

The 8x8° beam angle offers a narrow beam that can be used to highlight a small area in a building or making an ornament stand out.

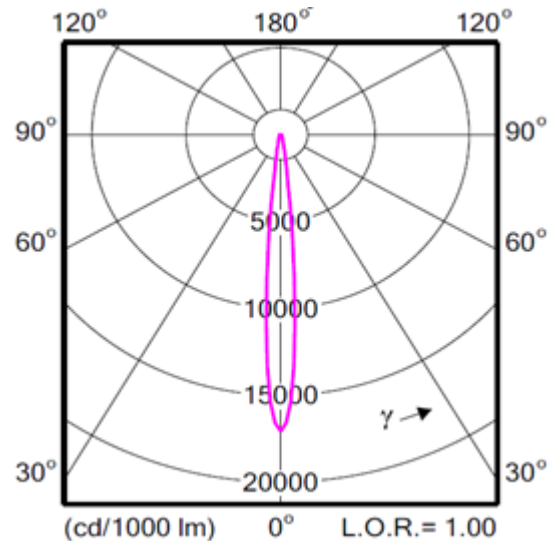

15x15° Beam Angle

Features:

The 15x15° beam angle offers a medium that can be used to highlight a small to medium area in a building or making an ornament stand out.

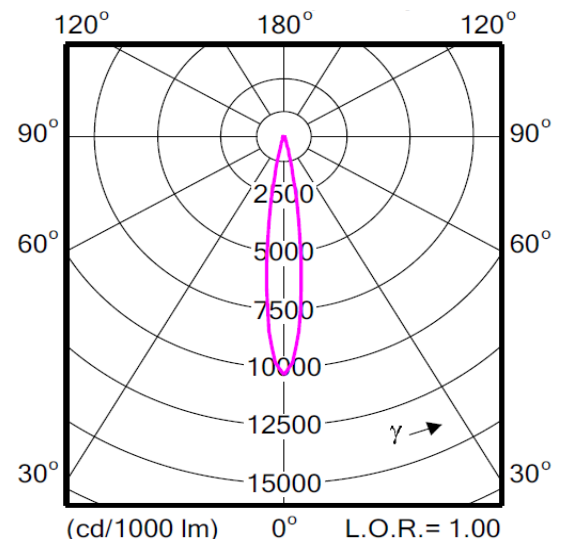

Polar Candela Distribution Curves:

30x30° Beam Angle

Features:

The 30x30° beam angle offers a wide beam that can be used for highlighting medium to large areas in a building or used for general façade lighting.

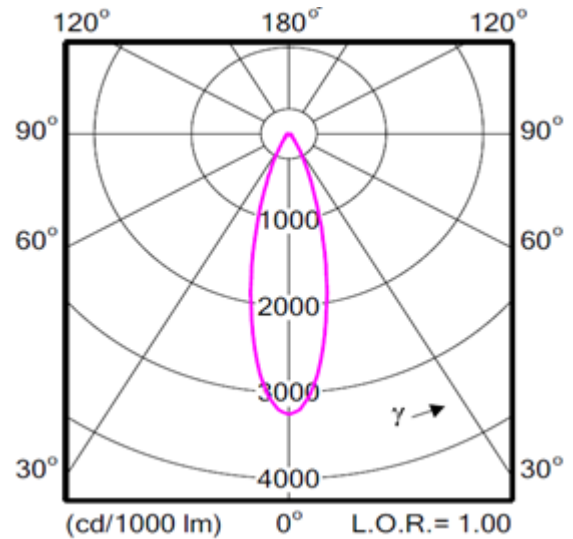

40x40° Beam Angle

Features:

The 40x40° beam angle offers a wide beam that can be used for highlighting large and wide areas in a building or used for general façade lighting.

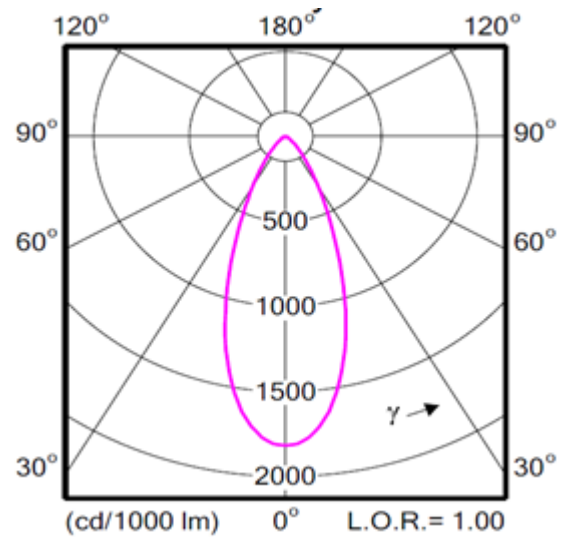

60x60° Beam Angle

Features:

The 60x60° beam angle offers a wide flood distribution that can be used to highlight larger and wider areas in a building or for general façade lighting.

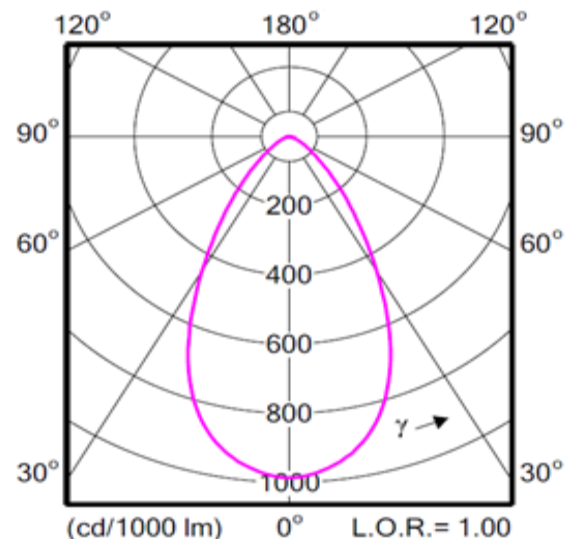

Order Information:

| Description |
|----------------------------------|
| BVP329 M 24LED 27K 220V 8 |
| BVP329 M 24LED 27K 220V 8 DMX |
| BVP329 M 24LED 30K 220V 8 |
| BVP329 M 24LED 30K 220V 8 DMX |
| BVP329 M 24LED 40K 220V 8 |
| BVP329 M 24LED 40K 220V 8 DMX |
| BVP329 M 24LED RGB 220V 8 DMX |
| BVP329 M 24LED RGBNW 220V 8 DMX |
| BVP329 M 36LED 27K 220V 8 |
| BVP329 M 36LED 27K 220V 8 DMX |
| BVP329 M 36LED 30K 220V 8 |
| BVP329 M 36LED 30K 220V 8 DMX |
| BVP329 M 36LED 40K 220V 8 |
| BVP329 M 36LED 40K 220V 8 DMX |
| BVP329 M 36LED RGB 220V 8 DMX |
| BVP329 M 36LED RGBNW 220V 8 DMX |
| BVP329 M 24LED 27K 220V 15 |
| BVP329 M 24LED 27K 220V 15 DMX |
| BVP329 M 24LED 30K 220V 15 |
| BVP329 M 24LED 30K 220V 15 DMX |
| BVP329 M 24LED 40K 220V 15 |
| BVP329 M 24LED 40K 220V 15 DMX |
| BVP329 M 24LED RGB 220V 15 DMX |
| BVP329 M 24LED RGBNW 220V 15 DMX |
| BVP329 M 36LED 27K 220V 15 |
| BVP329 M 36LED 27K 220V 15 DMX |

¹Other options are available upon request

Order Information:

| Description |
|----------------------------------|
| BVP329 M 36LED 30K 220V 15 |
| BVP329 M 36LED 30K 220V 15 DMX |
| BVP329 M 36LED 40K 220V 15 |
| BVP329 M 36LED 40K 220V 15 DMX |
| BVP329 M 36LED RGB 220V 15 DMX |
| BVP329 M 36LED RGBNW 220V 15 DMX |
| BVP329 M 24LED 27K 220V 30 |
| BVP329 M 24LED 27K 220V 30 DMX |
| BVP329 M 24LED 30K 220V 30 |
| BVP329 M 24LED 30K 220V 30 DMX |
| BVP329 M 24LED 40K 220V 30 |
| BVP329 M 24LED 40K 220V 30 DMX |
| BVP329 M 24LED RGB 220V 30 DMX |
| BVP329 M 24LED RGBNW 220V 30 DMX |
| BVP329 M 36LED 27K 220V 30 |
| BVP329 M 36LED 27K 220V 30 DMX |
| BVP329 M 36LED 30K 220V 30 |
| BVP329 M 36LED 30K 220V 30 DMX |
| BVP329 M 36LED 40K 220V 30 |
| BVP329 M 36LED 40K 220V 30 DMX |
| BVP329 M 36LED RGB 220V 30 DMX |
| BVP329 M 36LED RGBNW 220V 30 DMX |
| BVP329 M 24LED 27K 220V 40 |
| BVP329 M 24LED 27K 220V 40 DMX |
| BVP329 M 24LED 30K 220V 40 |
| BVP329 M 24LED 30K 220V 40 DMX |

¹Other options are available upon request

Order Information:

| Description |
|----------------------------------|
| BVP329 M 24LED 40K 220V 40 |
| BVP329 M 24LED 40K 220V 40 DMX |
| BVP329 M 24LED RGB 220V 40 DMX |
| BVP329 M 24LED RGBNW 220V 40 DMX |
| BVP329 M 36LED 27K 220V 40 |
| BVP329 M 36LED 27K 220V 40 DMX |
| BVP329 M 36LED 30K 220V 40 |
| BVP329 M 36LED 30K 220V 40 DMX |
| BVP329 M 36LED 40K 220V 40 |
| BVP329 M 36LED 40K 220V 40 DMX |
| BVP329 M 36LED RGB 220V 40 DMX |
| BVP329 M 36LED RGBNW 220V 40 DMX |

¹Other options are available upon request

Accessories:

| Description |
|---|
| BVP329 M glare shield (9 pcs) |
| ZXP390 Lead 4P DMX cable 2m (10 pcs) |
| ZXP390 Jump 4P DMX cable 2m (10 pcs) |
| ZXP390 endcap male connector (20 pcs) |
| ZXP390 endcap female connector (20 pcs) |

¹ Different cables lengths are available upon request

² End caps must be used at the end of each run

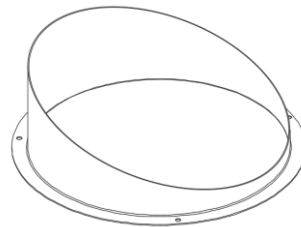

Glare Shield

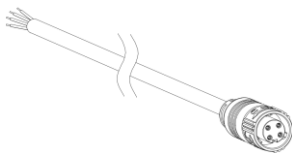

Leader cable 4P DMX 2m

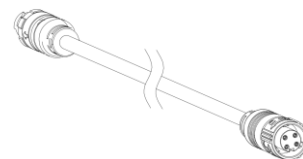

Jumper cable 4P DMX 2m

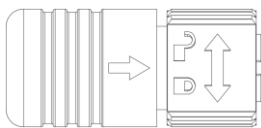

End cap for male connectors

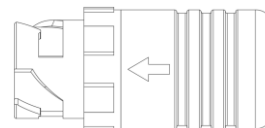

End cap for female connectors

Rated System Lumen Output ($\pm 10\%$):

18LED Version

| CCT/Color (All channels On) | 3.5° | |
|--------------------------------|--------|-------|
| | On/Off | DMX |
| 2700K | 2,393 | 2,345 |
| 3000K | 2,577 | 2,525 |
| 4000K | 2,934 | 2,875 |
| 5000K | 3,349 | 3,282 |
| RGB | – | 1,816 |
| Blue | 965 | 946 |
| Red | 1,511 | 1,481 |
| Green | 2,741 | 2,686 |
| Amber | 1,511 | 1,481 |
| Tunable White | – | 2,705 |

24LED Version

| CCT/Color (All channels On) | 8° | | 15° | | 30° | | 40° | | 60° | |
|--------------------------------|--------|-------|--------|-------|--------|-------|--------|-------|--------|-------|
| | On/Off | DMX | On/Off | DMX | On/Off | DMX | On/Off | DMX | On/Off | DMX |
| 2700K | 3,039 | 2,978 | 3,254 | 3,189 | 3,039 | 2,978 | 3,039 | 2,978 | 2,872 | 2,851 |
| 3000K | 3,272 | 3,207 | 3,503 | 3,433 | 3,272 | 3,207 | 3,272 | 3,207 | 3,092 | 3,030 |
| 4000K | 3,725 | 3,651 | 3,988 | 3,909 | 3,725 | 3,651 | 3,725 | 3,651 | 3,520 | 3,450 |
| 5000K | 4,252 | 4,167 | 4,553 | 4,461 | 4,252 | 4,167 | 4,252 | 4,167 | 4,018 | 3,938 |
| RGB | – | 2,306 | – | 2,469 | – | 2,306 | – | 2,306 | – | 2,179 |
| RGBNW | – | 2,642 | – | 2,829 | – | 2,642 | – | 2,642 | – | 2,497 |
| RGBWW | – | 2,534 | – | 2,713 | – | 2,534 | – | 2,534 | – | 2,395 |
| Blue | 1,225 | 1,201 | 1,312 | 1,286 | 1,225 | 1,201 | 1,216 | 1,191 | 1,158 | 1,135 |
| Red | 1,919 | 1,881 | 2,055 | 2,014 | 1,919 | 1,881 | 1,919 | 1,881 | 1,809 | 1,773 |
| Green | 3,480 | 3,411 | 3,726 | 3,651 | 3,480 | 3,411 | 3,480 | 3,411 | 3,289 | 3,223 |
| Amber | 1,919 | 1,881 | 2,055 | 2,014 | 1,919 | 1,881 | 1,919 | 1,881 | 1,809 | 1,773 |
| Tunable White | – | 3,435 | – | 3,677 | – | 3,435 | – | 3,425 | – | 3,246 |

Rated System Lumen Output ($\pm 10\%$):

36LED Version

| CCT/Color (All channels On) | 8° | | 15° | | 30° | | 40° | | 60° | |
|--------------------------------|--------|-------|--------|-------|--------|-------|--------|-------|--------|-------|
| | On/Off | DMX | On/Off | DMX | On/Off | DMX | On/Off | DMX | On/Off | DMX |
| 2700K | 4,331 | 4,244 | 4,635 | 4,542 | 4,331 | 4,244 | 4,331 | 4,244 | 4,093 | 4,011 |
| 3000K | 4,663 | 4,569 | 4,990 | 4,890 | 4,663 | 4,569 | 4,663 | 4,569 | 4,406 | 4,318 |
| 4000K | 5,309 | 5,203 | 5,681 | 5,568 | 5,309 | 5,203 | 5,309 | 5,203 | 5,107 | 4,917 |
| 5000K | 6,060 | 5,939 | 6,485 | 6,355 | 6,060 | 5,939 | 6,060 | 5,939 | 5,727 | 5,612 |
| RGB | – | 3,286 | – | 3,516 | – | 3,286 | – | 3,286 | – | 3,105 |
| RGBNW | – | 3,765 | – | 4,029 | – | 3,765 | – | 3,765 | – | 3,558 |
| RGBWW | – | 3,611 | – | 3,864 | – | 3,611 | – | 3,611 | – | 3,412 |
| Blue | 1,746 | 1,711 | 1,869 | 1,831 | 1,746 | 1,711 | 1,746 | 1,711 | 1,650 | 1,617 |
| Red | 2,729 | 2,674 | 2,920 | 2,861 | 2,729 | 2,674 | 2,729 | 2,674 | 2,579 | 2,527 |
| Green | 4,960 | 4,860 | 5,307 | 5,201 | 4,960 | 4,860 | 4,960 | 4,860 | 4,687 | 4,593 |
| Amber | 2,729 | 2,674 | 2,920 | 2,861 | 2,729 | 2,674 | 2,729 | 2,674 | 2,579 | 2,527 |
| Tunable White | – | 4,895 | – | 5,238 | – | 4,895 | – | 4,895 | – | 4,626 |

